

MADE IN AUSTRALIA

ROOF ZIPSTM

FAST / EASY / VERSATILE

The revolutionary new roof fastener from Buildex[®]

FAST

Quicker to start with improved drill performance

EASY

Easier to start and use, even on a steep sloping roof or near the edge of the sheeting

VERSATILE

Can be used for multiple applications, replacing your Tek[®] and Type 17's:

- fixing to timber
- fixing to steel purlins up to 1.9mm thick
- fixing to thin metal battens
- one class coating



FIXING TO TIMBER



FIXING TO THIN METAL BATTENS



FIXING TO STEEL PURLINS

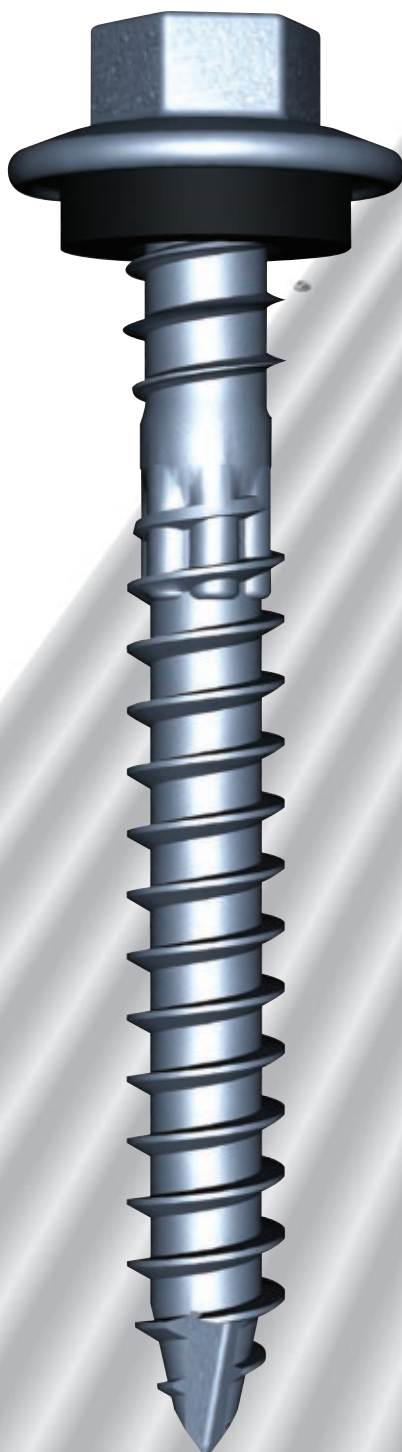

PATENT PROTECTED

- ✓ **Hardwood**
- ✓ **Softwood**
- ✓ **Thin Metal Battens**
- ✓ **1.2mm Steel Purlins**
- ✓ **1.6mm Steel Purlins**
- ✓ **1.9mm Steel Purlins**



ROOF ZIPS™

FAST / EASY / VERSATILE

The revolutionary new roof fastener designed, developed and proudly manufactured here in Australia by ITW Buildex®. Roof Zips™ will make all other roof fastening systems obsolete.



As Australia's leading manufacturer and supplier of self drilling screws, ITW Buildex® is committed to developing fastening solutions based on innovative products.

For the past two years, Buildex® has been working closely with the roofing industry around Australia to understand and identify how roofing contractors currently fasten steel roof sheeting. The objective being to develop a fastener specifically aimed at exceeding the roof fixers current fastener requirements. These were identified as:



FAST AND EASY TO USE



EASY TO DRILL ON STEEP SLOPING ROOFS



EDGE OF SHEETING

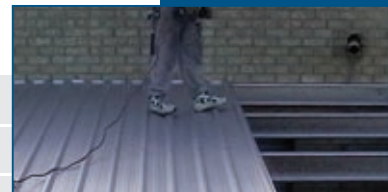

FIXES TO STEEL PURLINS UP TO 1.9mm THICK



FIXES TO THIN METAL BATTENS



FIXES TO TIMBER BATTENS

- ❶ **FAST**
 - Improve drill performance
 - Quicker to start
 - Consistent performance
- ❷ **EASY**
 - Reduce washer damage
 - Eliminate crest sliding
 - Less end load pressure
 - Easier to start and use even in difficult applications
- ❸ **VERSATILE**
 - Applicable for different roofing profiles
 - Applicable for multiple host materials
 - One class coating

Roof Zips™ is a patent protected 'new generation fastener'— the one fastener solution which takes the fastening of steel roof sheeting into a whole new dimension. Roof Zips™ not only meets but exceeds roof fixers current fastener requirements:

- ❶ **Faster to install – saving time and money.**
- ❷ **Easier to use, requiring less end load pressure.**
- ❸ **Can be drilled on steep sloping roofs or near the edge of sheeting.**
- ❹ **Reduces the amount of swarf.**
- ❺ **Will not cause skidding of the roof profile.**
- ❻ **Has multiple product applications of fixing to timber battens, steel purlins up to 1.9mm thick and thin metal battens.**
- ❼ **Reduces damage to the washer – eliminating water entry.**
- ❽ **Designed, developed and proudly manufactured in Australia.**
- ❾ **Fully covered by the Buildex® warranty.**
- ❿ **Includes the Buildex® features HiGrip® and Shankguard®.**
- ⓫ **Climaseal® 4 coating which meets AS3566 Class 4.**
- ⓬ **Significantly reduces stock holdings for both distributors and roofing contractors.**

ROOF ZIPS

FAST / EASY / VERSATILE

Unique product features

The new **head design** has a 10% larger surface area and a more pronounced concave shape than conventional products, to hold the sealing washer more securely. This reduces the common problem of washer damage.

HiGrip® design feature grips the sheeting to provide a positive join. This prevents water entry, restricts over-drilling and stops the roof sheet moving down the shank when the roof is walked on.

Climaseal® 4 coating meets AS3566 Class 4, enabling it to be used externally virtually anywhere.

Look for the **BX Z4** symbol on the screw head. It's your sign of quality. **BX** = Buildex, **Z** = Roof Zips, **4** = Class 4

The unique **Shankguard®** design feature provides maximum resistance to corrosion. It protects the fastener shank from scratching and scouring that can occur when crest fixing metal roofing. This in turn keeps the corrosion coating intact and fully functioning, providing 60% more corrosion resistance.

Specially designed **buttress thread** which, unlike conventional threads, has 30 degree angle on one side and 7 degree angle on the other. This reduces distortion when fixing to steel purlins or metal battens. As a result there is a stronger and more robust connection, greater pullout strength and a better ability to handle movement of steel sheeting.

The unique patent protected **point design** allows for quick and easy installation into timber battens, steel purlins up to 1.9mm thick and thin metal battens. The new point eliminates burring which can cause washer damage and allows for easy installation on a steep sloping roof or for close-to-the-edge fastening. It will eliminate skidding and scratching of the roof profile.

PATENT PROTECTED

Roof Zips™



12x50 Type 17



• Class 3 • Class 4

Fixing to timber battens

12x35 Tek®



• Class 3 • Class 4

Fixing to steel purlins

12x45 Tek®

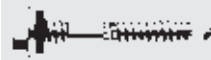

• Class 3 • Class 4

Fixing to steel purlins

13x41/55 Metal Batten Tek®



• Class 3 • Class 4

Fixing to thin metal battens

ROOF ZIPS™

FAST / EASY / VERSATILE



HexHd

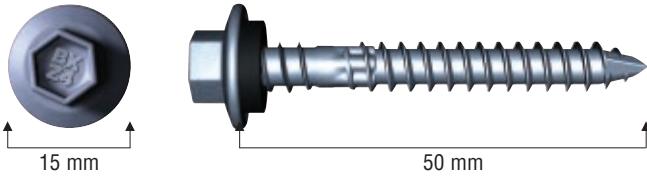

Gauge	Threads Per Inch (TPI)	Length (mm)
M6	11	50

Part Number	Description	Pack Type	Pack Size
6-030-3306-1C4	M6 x 50mm Hex Head H/G seal	Bulk	1,000
1-030-9306-1TPC4	M6 x 50mm Hex Head H/G seal	Trade Pack	100

Performance Data

Single Shear Strength	8.5kN
Axial Tensile Strength	15.4kN
Torsional Strength	14Nm

Pullout Strength

HOST MATERIAL	(kN)
0.55mm Batten	1.9kN
1.2mm Steel Purlin	3.2kN
1.6mm Steel Purlin	4.8kN
1.9mm Steel Purlin	6.2kN
F5 Pine - 30mm embedment	5.4kN
F5 Pine - 35mm embedment	6.3kN
F17 Hardwood - 30mm embedment	6.3kN
F17 Hardwood - 35mm embedment	7.2kN

Values given are actual averages obtained under laboratory conditions. Appropriate safety factors should be applied for design purposes.

Installation Instructions



Using a Buildex 5/16" hex socket, fit to a power screwdriver (Tek Gun). Set up to 2,500rpm. Put screw into driver and place at fastening position. Squeeze trigger and maintain firm end pressure until screw has drilled and fastened.

Applications

For fixing:

- corrugated steel roofing profiles to **timber battens**
- all steel roofing profiles to **thin metal battens** and **steel purlins** up to 1.9mm thick

ITW Buildex
A DIVISION OF ITW AUSTRALIA PTY LTD

A.C.N. 004 235 063
A.B.N. 63 004 235 063 008

600 South Road (PO Box 1154)
Moorabbin, Vic, 3189, Australia
Telephone: +61 3 9555 6433
www.buildex.com.au



For Sales orders:
Phone: 1300 368 101
Fax: 1800 456 448

Technical Help Desk
Phone: 1300 137 273
Fax: 1800 137 272
Email: technicalhelpdesk@buildex.com.au

Visit us at
WWW.
[buildex.com.au](http://www.buildex.com.au)

